

ELEVATIE/ELEVATION

Sc. 1:20

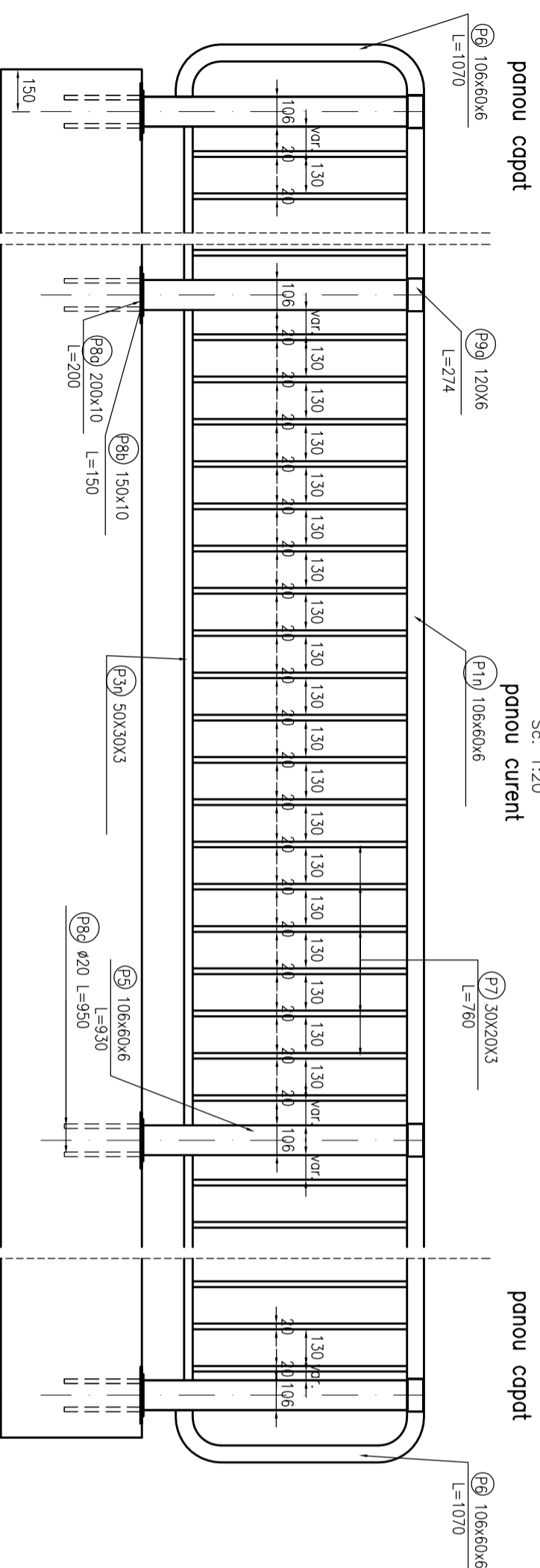

SECTIUNE TRANSVERSALA

CROSS SECTION

Sc. 1:20

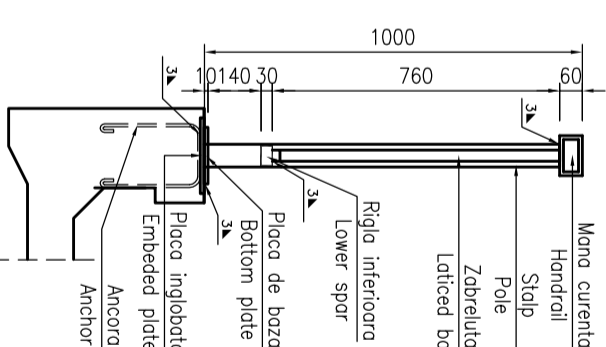

DISPUNERE TIPURI PANOURI/DISPOSSAL PANEL TYPE

Sc. 1:100

19800

SATU MARE

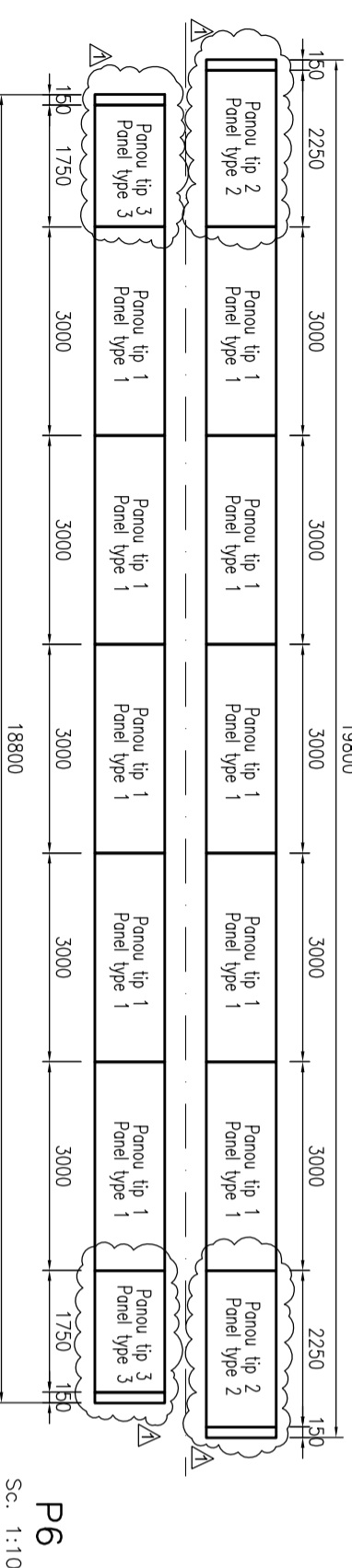

Dispunerea ancorelor pe placa de baza inglobata

Disposal of anchors on embedded plate

Sc. 1:10

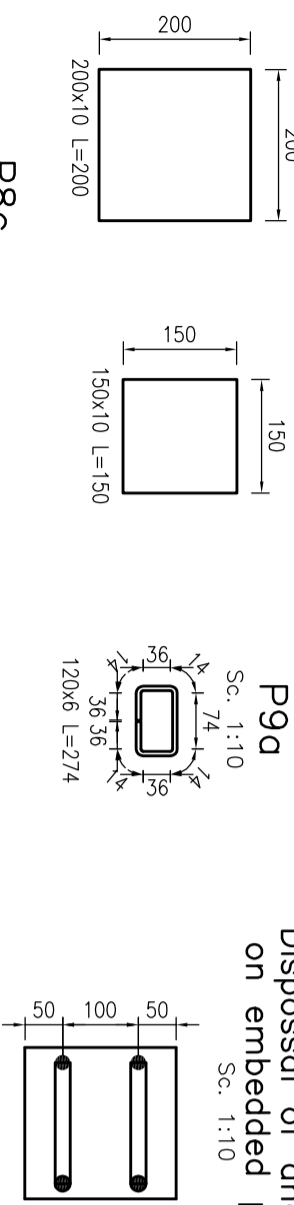

Sc. 1:10

Sc. 1:10

Sc. 1:10

Sc. 1:10

Nota:  
1. Toate cotele sunt in mm  
2. „n” este numarul panoului

M	ELEMENTE	DIMENSIUNI	LUNGIME	g/ml	g/buc.	Nr	G total
P11	Mana curenta	106x60x6	3000	14.51	43.53	10	435.30
P12	Mana curenta	106x60x6	2250	14.51	32.65	2	65.30
P13	Mana curenta	106x60x6	1750	14.51	25.39	2	50.79
P31	Riga inferioara	50x30x3	2894	3.49	10.10	10	101.00
P32	Riga inferioara	50x30x3	2144	3.49	7.48	2	14.97
P33	Riga inferioara	50x30x3	1644	3.49	5.74	2	11.48
P5	Stalp	106x60x6	930	14.51	13.49	14	188.92
P6	Mana curenta	106x60x6	165	14.51	2.39	4	9.56
P7	Zabrelute	50x20x3	760	2.07	1.57	238	374.42
P8a	Placa inglobata	200x10	200	15.70	3.14	14	43.96
P8b	Placa inglobata	150x10	150	11.78	1.77	14	24.74
P8c	Ancora	ø20	950	2.47	2.35	28	65.70
P9a	Manson	120x6	274	5.65	1.55	14	21.67
TOTAL POD (kg)							1386.12

BENEFICIAR/CLIENT  
COMPANIA NATIONALA DE AUTOSTRAZI  
SI DRUMURI NATIONALE DIN ROMANIA  
NATIONAL COMPANY OF MOTORWAYS  
AND NATIONAL ROADS IN ROMANIA

**STRABAG**  
STRABAG AG  
sector 5 Calea 13 Septembrie nr. 90  
050726 Bucuresti, Romania  
Phon +40 21/403 4395

Pöyry Infra GmbH  
10 Montreal Square, 1st floor, opt 1.22,  
Bucharest, Romania  
Phon +40 21/300 29 30

DIRECTOR PROJECT  
Ing. Karl Herrmann  
PROJECT MANAGER  
SEF PROJECT DEWURI  
Ing. Ionut Panita  
TEAM LEADER

PROIECTAT  
DESIGNED  
Ing. Clancu

VERIFICATOR INTERN  
INTERNAL CHECKER  
Ing. Reinhold Witten

Date: 24.02.2010  
Date: 24.02.2010

Score: 1:10 1:20  
Score: 1:100  
Contract no. 6R2  
Contract No. 6R2

Descriere  
Description  
REWIZII/REVISIONS

REABILITARE DE DRUM DN 19 ORADEA – SATU MARE  
LOT A DN 19 ORADEA – SATU MARE  
ROADS REHABILITATION DN 19 ORADEA – SATU MARE  
LOT A DN 19 ORADEA – SATU MARE

FAZA : DETALII DE EXECUTIE  
STATUS : DETAILED DESIGN

SECTIUNEA 6R2  
SUB – SECTION 6R2

POD PESTE PARAUUL COSMO KM.18+726/  
BRIDGE OVER COSMO CREEK KM.18+726  
PARAPET PIETONAL/  
PEDESTRAIN GUARDRAIN

Cod desen : 6R2 / 19 / BR / 018  
Drawing number:

Revizii nr. 1  
Rev. No. 1